



**ASM 390, universal  
voltage, configurable I/O  
interface board, outlet  
DN 25 ISO-KF**

# ASM 390



## ASM 390, universal voltage, configurable I/O interface board, outlet DN 25 ISO-KF

- Dry and clean pump with high backing pump capacity (35 m<sup>3</sup>/h)
- Minimum test time: unrivalled performance on small and large specimens
- Slim design and high maneuverability
- Large color touch screen, fully rotatable and detachable without any tool
- Integrated toolbox for storing accessories
- Fully configurable I/O interface (37 pins D-Sub) for control via PCs/PLCs
- Connectable DN 25 exhaust for connection to a general Fab exhaust

## Dimensions

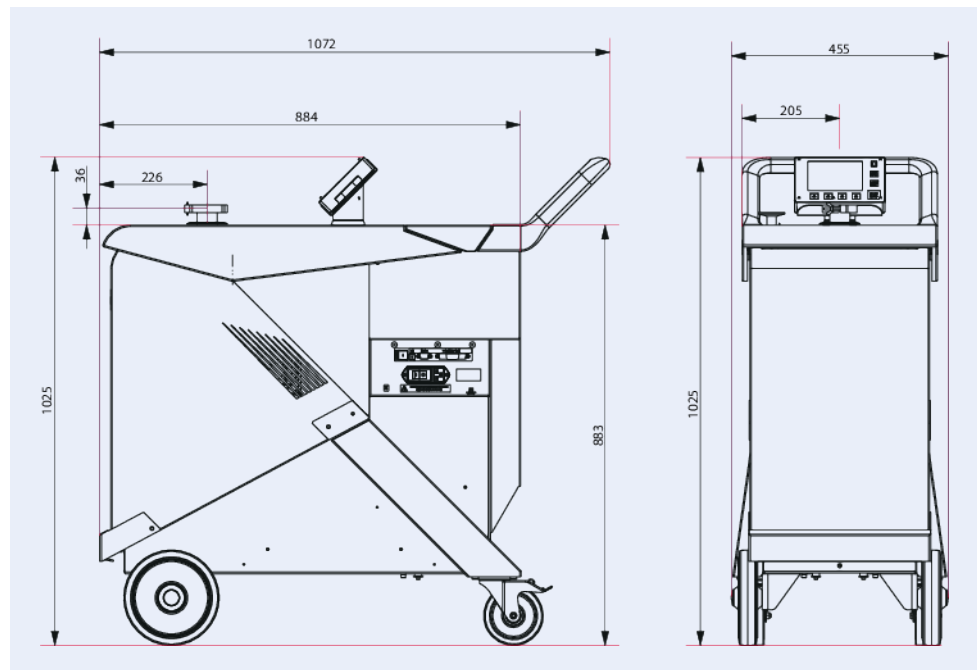

Technical Data	ASM 390, universal voltage, configurable I/O interface board, outlet DN 25 ISO-KF		
Pumping speed backing pump	35 m³/h		
Pumping speed for He	10 l/s		
Test method	Vacuum leak detection   Sniffing leak detection		
I/O interfaces	RS232, USB		
Interface: Connection, device side	Configurable 37 pins I/O		
Type	High performance - mobile		
Minimum detectable leakage rate for helium (vacuum leak detection)	$1 \cdot 10^{-13}$ Pa m³/s		
User interface	Graphic color touch screen (detachable)		
Backing pump capacity	35 m³/h		
Operating temperature	10 – 35 °C		
Start-up time (20°C)	2 min		
Exhaust connection	DN 25 ISO-KF		
Input voltage(s)	100 – 240 V AC, 50/60 Hz		
Emission sound pressure level (EN ISO 2151)	55 dB(A)		
Start-up time (20°C)	2 min		
Pumping speed for He	10 l/s		
Minimum detectable leakage rate for helium (sniffing leak detection)	$1 \cdot 10^{-9}$ Pa m³/s	$1.33 \cdot 10^{-7}$ Torr l/s	$1 \cdot 10^{-7}$ mbar l/s
Weight	125 kg   275.58 lb		
Detectable gases	<sup>4</sup> He   <sup>3</sup> He   H <sub>2</sub>		
Power consumption	800 W		
Dimensions (L x W x H)	1072 x 455 x 1025 mm		
Power consumption max.	1,600 W		
Backing pump	With oil-free backing pump		
Weight	125 kg		
Connection flange (in)	DN 40 ISO-KF		
Connection flange (out)	DN 25 ISO-KF		

Order number	ASM 390, universal voltage, configurable I/O interface board, outlet DN 25 ISO-KF
ASM 390, universal voltage, configurable I/O interface board, outlet DN 25 ISO-KF	CSGB01G2MM9B

## Your Success. Our Passion.

We give our best for you every day –  
worldwide!

Are you looking for an optimum vacuum solution?

Talk to us:  
Pfeiffer Vacuum GmbH  
Germany  
T +49 6441 802-0

Or scan the barcode, to visit our web page:



<https://webportal.pfeiffer-vacuum.com/global/en/contact>



Errors and/or changes excepted. - 9/7/2024

Follow Us On Social Media  
#pfeiffervacuum



[www.pfeiffer-vacuum.com](http://www.pfeiffer-vacuum.com)

**PFEIFFER**  **VACUUM**